

LAKE ASHTON COMMUNITY DEVELOPMENT DISTRICT 1 ROADWAY IMPROVEMENTS

OWNER / DEVELOPER

LAKE ASHTON COMMUNITY DEVELOPMENT DISTRICT 1 (LACDD1)

C/O GOVERNMENTAL MANAGEMENT SERVICES - CENTRAL FLORIDA, LLC
201 EAST PINE STREET, SUITE 550
ORLANDO, FLORIDA 32801

CONTACT: GEORGE S. FLINT
P - (407) 841-5524
F - (407) 839-1526
GFLINT@GOVMGTSVC.COM

CIVIL ENGINEER

PBS&J
482 SOUTH KELLER RD
ORLANDO, FL 32810

CONTACT: BRIAN FORSTER, P.E.
P - (407) 647-7275
F - (407) 647-0551
BPFORSTER@PBSJ.COM

VICINITY MAP

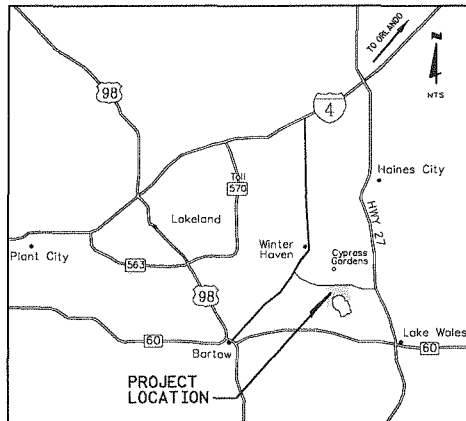

INDEX OF DRAWINGS

DWG. NO.	DRAWING TITLE
G100	COVER AND INDEX OF DRAWINGS
G101	GENERAL NOTES AND PAY ITEM LIST
C100	OVERALL SITE PLAN
C101-103	ROADWAY REPAIR PLAN
C110-111	DETAILS

PREPARED BY



ENGINEERING • PLANNING • ARCHITECTURE
482 SOUTH KELLER ROAD
ORLANDO, FLORIDA 32810
(407) 647-7275

MARCH 11, 2011

LOCATION MAP

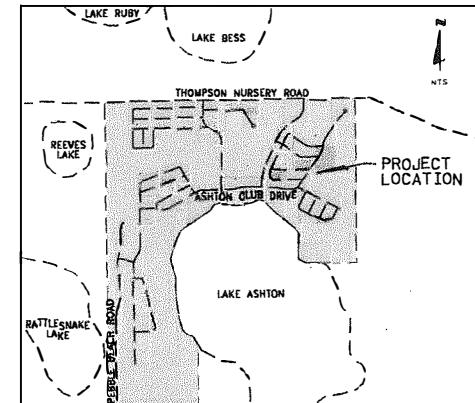

GENERAL

1. INSTALL ALL REQUIRED EROSION AND SEDIMENTATION CONTROL MEASURES PRIOR TO DEMOLITION.
2. THE LOCATION OF ALL EXISTING UTILITIES AND DRAINAGE STRUCTURES SHOWN ARE BASED ON AVAILABLE INFORMATION. PRIOR TO CONSTRUCTION, CONTRACTOR SHALL FIELD LOCATE ALL EXISTING FACILITIES WITHIN AND ADJACENT TO THE LIMITS OF CONSTRUCTION.
3. ALL ROADWAY CONSTRUCTION SHALL BE COMPLETED IN ACCORDANCE WITH THE FLORIDA DEPARTMENT OF TRANSPORTATION DESIGN STANDARDS AND STANDARD SPECIFICATIONS FOR ROAD AND BRIDGE CONSTRUCTION, 2008.
4. CONTRACTOR SHALL MAINTAIN DAILY RECORD DRAWINGS INCLUDING DATA RELATED TO ALL SURFACE FEATURES AT ALL TIMES DURING CONSTRUCTION. RECORD DRAWING INFORMATION SHALL INCLUDE (AT A MINIMUM) HORIZONTAL LOCATIONS AND INVERT ELEVATIONS, AND CLEARANCE DISTANCES BETWEEN PIPE CROSSINGS (AND TOP ELEVATION IF APPLICABLE) OF ALL DRAINAGE AND UTILITY PIPE SYSTEMS INCLUDING IRRIGATION SLEEVES AND MATERIALS AND SIZES OF ALL DRAINAGE AND UTILITY FEATURES. INFORMATION SHALL BE LEGIBLY HAND WRITTEN ON THE MOST CURRENT SET OF CONSTRUCTION DRAWINGS, AS WELL AS TYPE WRITTEN IN TABULAR FORMAT. UPON COMPLETION OF THE PROJECT SUBMIT ONE COMPLETE SET OF RECORD DRAWINGS CERTIFIED BY A PROFESSIONAL LAND SURVEYOR REGISTERED IN THE STATE OF FLORIDA.
5. CONSTRUCTION SITE ACCESS SHALL BE VIA THOMPSON NURSERY ROAD (C.R. 540A). THE ACCESS TO AND FROM THE SITE MAY, FROM TIME TO TIME, CHANGE AT THE DIRECTION OF THE OWNER.
6. CONTRACTOR TO MAINTAIN, AT NO EXPENSE TO THE OWNER, ALL NECESSARY ROADS FOR HAULING THE EXCAVATED MATERIAL. CONTRACTOR TO REMOVE AND HAUL EXCESS MATERIAL FROM SITE.
7. EVERYONE PRESENT AT THE SITE MUST ABIDE BY OSHA AND JOB SAFETY REGULATIONS AT ALL TIMES.
8. CONTRACTOR TO PROVIDE A SCHEDULE OF PROPOSED CONSTRUCTION TO THE OWNER AND ENGINEER PRIOR TO COMMENCING ACTIVITIES.

GEOTECHNICAL INFORMATION

1. EXISTING PAVEMENT AND GROUNDWATER TABLE INFORMATION WAS OBTAINED FROM:
 - FLORIDA TESTING & ENVIRONMENTAL, INC. (FTE) REPORT, "PAVEMENT EVALUATION REPORT-EXISTING LAKE ASHTON PROJECT" DATED AUGUST 4, 2008.
 - "SUBSURFACE SOIL EXPLORATION - PHASE I, EMMER DEVELOPMENT CORPORATION" ARDAMAN & ASSOCIATES, DATED APRIL 5, 1985.

PAY ITEM LIST

PAY ITEM NO.	DESCRIPTION	UNIT	QUANTITY (BY ROADWAY)						QUANTITY TOTAL
			LAKE ASHTON BLVD.	ASHTON CLUB DR.	TURNBERRY LANE	STRATHMORE DR.	TROON LANE	DUNMORE DR.	
0101-1	MOBILIZATION	LS							1
0102-1	MAINTENANCE OF TRAFFIC	LS							1
0104-10-3	SEDIMENT BARRIER	LF	3,800	508	40		20	2,574	6,942
0104-18	INLET PROTECTION SYSTEM	EA	13	4	14	12	2	8	53
0110-2-1	CLEARING AND GRUBBING	AC	1.29	0.05					1.35
0110-4	REMOVAL OF EXISTING CONCRETE PAVEMENT	SY	42	21	14		4		82
0120-1	REGULAR EXCAVATION	CY	128		114				242
0160-4	STABILIZATION (6")	SY	295		285				580
0210-1-1	REWORKING LIMEROCK BASE (6")	SY	5,893		256				6,149
0285-704	OPTIONAL BASE GROUP 4 (LIMEROCK) (LBR 100)	SY	295		255				550
0327-70-19	MILLING EXISTING ASPH PAVT (3/4")	SY						4,539	4,539
0334-1-12	SUPERPAVE ASPHALTIC CONCRETE (TRAFFIC B)	TN	512	43				250	805
0350-1-1	PLAIN CEMENT CONCRETE PAVEMENT (6")	SY			5				5
0520-1-10	CONCRETE CURB & GUTTER (TYPE F)	LF	10						10
0520-1-8	CONCRETE CURB & GUTTER (SPECIAL, MIAMI)	LF	180	95	40		20	10	345
0526-1-1	PAVERS (ARCHITECTURAL, ROADWAY)	SY	19						19
0570-1-2	PERFORMANCE TURF, SOD	SY	1,075	59				763	1,897
	HOT POUR ASPHALT SEALANT (RC-70)	LF			7,128	6,029			13,157
	THIN LIFT PAVING (3/4")	SY			4,882	4,212			9,094
	STRIP DRAIN	LF	3,628	199				2,574	6,401

EROSION CONTROL

1. PROVIDE EROSION AND SEDIMENTATION CONTROL MEASURES UTILIZING INDUSTRY STANDARD BEST MANAGEMENT PRACTICES TO AVOID ADVERSE IMPACTS TO OFF SITE LANDS AND WATER BODIES. MAINTAIN THESE MEASURES DAILY UNTIL CONSTRUCTION ACCEPTANCE BY THE OWNER AND THEN REMOVE AND LEGALLY DISPOSE OF SAID MEASURES. CONTRACTOR TO PROVIDE STORMWATER POLLUTION PREVENTION PLAN (SWPPP) TO ENGINEER FOR REVIEW PRIOR TO COMMENCEMENT OF CONSTRUCTION ACTIVITIES. CONTRACTOR TO HAVE SWPPP ON SITE AT ALL TIMES.
2. ALL STORM DRAINAGE INLETS AND PIPES SHALL BE PROTECTED FROM SILT, SAND AND DEBRIS DURING CONSTRUCTION. MAINTAIN THESE MEASURES DAILY (WHICH MAY INCLUDE FULL REPLACEMENT) TO MINIMIZE SILT ACCUMULATION IN THE STORM DRAINAGE SYSTEM. ANY ACCUMULATION WITHIN THE STORM DRAINAGE PIPE SYSTEM SHALL BE REMOVED WITHOUT PUMPING OR FLUSHING INTO THE PONDS. STORM DRAINAGE SYSTEM SHALL BE CLEANED AND FREE OF DEBRIS PRIOR TO CONSTRUCTION MANAGER'S ACCEPTANCE.
3. NO DISCHARGE OF CONTAMINANTS INTO ADJACENT WETLANDS, WATER BODIES, OR UPLAND BUFFERS WILL BE PERMITTED AT ANY TIME.
4. DAMAGE TO WETLANDS AND/OR UPLAND BUFFERS ADJACENT TO CONSTRUCTION AREAS SHALL BE PREVENTED BY DELINEATING THE LIMITS OF CONSTRUCTION, AND INSTALLING SEDIMENT BARRIERS PRIOR TO THE COMMENCEMENT OF CONSTRUCTION ACTIVITIES. THEREBY RETAINING SEDIMENT WITHIN THE CONSTRUCTION AREA. CONTRACTORS WILL BE REQUIRED TO ADEQUATELY MAINTAIN THESE PROTECTION MEASURES AT ALL TIMES.
5. ALL SURFACE WATER DISCHARGE FROM SITE, INCLUDING DEWATERING DISCHARGE, SHALL MEET STATE WATER QUALITY STANDARDS (LESS THAN 29 NTU ABOVE BACKGROUND) PRIOR TO REACHING ANY WATERS OF THE STATE INCLUDING WETLANDS. IT IS THE CONTRACTOR'S RESPONSIBILITY TO REMAIN IN COMPLIANCE WITH THE FDEP GENERAL PERMIT TO DISCHARGE PRODUCED GROUNDWATER OFFSITE.
6. EROSION AND DUST CONTROL SHALL BE MAINTAINED WITHIN CONSTRUCTION AREAS BY QUICKLY STABILIZING DISTURBED AREAS TO PREVENT THE RELEASE OF SEDIMENT.

ROADWAY

1. SAWCUT EXISTING PAVEMENT AT THE CONNECTIONS TO THE EXISTING ROADWAYS TO FORM A STRAIGHT PAVEMENT JOINT.
2. ALL CURBS (EXISTING OR NEW) SHALL BE PROTECTED FROM CONSTRUCTION DAMAGE. ALL CHIPPED OR CRACKED PORTIONS OF CURB SHALL BE REPLACED AT NO ADDITIONAL COST TO THE OWNER. IN ADDITION, ANY MORTAR, CONCRETE, SOIL AND OTHER DEPOSITS OR STAINS SHALL BE CLEANED TO RETURN THE CURBS TO THEIR ORIGINAL CONDITION OR BETTER.
3. DIMENSIONS OF MIAMI CURB ARE TO MATCH EXISTING MIAMI CURB.
4. UPON COMPLETION OF FINAL ASPHALT PAVING, TOOL AND CLEAN ALL MANHOLE AND VALVE COVERS OF DIRT, DEBRIS AND ASPHALT. ALL MANHOLE AND VALVE COVERS SHALL BE CLEAN AND OPERABLE PRIOR TO CONSTRUCTION MANAGER'S ACCEPTANCE.
5. QUANTITIES FOR ASPHALT REMOVAL IN SECTIONS OF FULL DEPTH ROADWAY REPAIR ARE INCLUDED UNDER CLEARING AND GRUBBING PAY ITEM 0110-2-1.
6. THE SIZE AND WEIGHT OF THE EQUIPMENT USED FOR MILLING ASPHALT CONCRETE PAVEMENT SHALL BE SELECTED TO AVOID CRACKING OF THE EXISTING ASPHALT PAVEMENT THAT WILL REMAIN AFTER MILLING. ANY AREAS WHERE THE REMAINING ASPHALT PAVEMENT HAS BEEN CRACKED OR LOOSENED BY THE MILLING OPERATION SHALL BE REMOVED AND REPLACED WITH NEW TYPE SP ASPHALTIC CONCRETE. THE SURFACE ELEVATION SHALL MATCH THE MILLED SURFACE AT NO ADDITIONAL COST TO THE OWNER.

MAINTENANCE OF TRAFFIC

1. THE CONTRACTOR SHALL PREPARE A PROJECT SPECIFIC TEMPORARY TRAFFIC CONTROL PLAN (TCP) THAT CONFORMS TO THE REQUIREMENTS OF THE FHWA MANUAL ON UNIFORM TRAFFIC CONTROL DEVICES (2009) AND THE FOOT DESIGN STANDARDS (2010) INCLUDING CURRENT REVISIONS AND ADDENDA. THE TCP SHALL BE PREPARED AND SIGNED AND SEALED BY A PROFESSIONAL ENGINEER LICENSED IN THE STATE OF FLORIDA AND SUBMITTED TO THE ENGINEER FOR REVIEW AND APPROVAL WITHIN TEN WORKING DAYS AFTER RECEIVING A NOTICE TO PROCEED. NO WORK SHALL OCCUR WITHOUT AN APPROVED TCP. THE COST FOR PREPARING THE TCP SHALL BE INCLUDED IN THE LUMP SUM PRICE FOR MAINTENANCE OF TRAFFIC PAY ITEM 102-1.
2. THE TCP SHALL INCLUDE TEMPORARY TRAFFIC CONTROL MEASURES OUTSIDE THE GATED ENTRANCE ON LAKE ASHTON BOULEVARD AS REQUIRED FOR LANE CLOSURES ON LAKE ASHTON BOULEVARD.
3. INSTALL TEMPORARY TRAFFIC CONTROL DEVICES CALLED FOR IN THE APPROVED TCP BEFORE BEGINNING THE ASSOCIATED WORK. PROVIDE ADDITIONAL TRAFFIC CONTROL DEVICES AS CONDITIONS WARRANT AS DIRECTED BY THE ENGINEER. THE LUMP SUM BID PRICE FOR MAINTENANCE OF TRAFFIC PAY ITEM 102-1 SHALL INCLUDE PROVIDING, MAINTAINING, INSTALLING AND REMOVING ALL TEMPORARY TRAFFIC CONTROL DEVICES.
4. IN THE EVENT OF ACCIDENTS, SEVERE WEATHER CONDITIONS OR OTHER UNFORESEEN EMERGENCIES, THE CONTRACTOR SHALL ADJUST OR REMOVE TRAFFIC CONTROL DEVICES AS DIRECTED BY THE ENGINEER WITHOUT DELAY. THE COST FOR REMOVING AND RESTORING THE TCP SHALL BE INCLUDED IN THE LUMP SUM PRICE FOR MAINTENANCE OF TRAFFIC PAY ITEM 102-1.
5. THE CONTRACTOR SHALL NOT CLOSE LANES ON DUNMORE DRIVE AT THE SAME TIME LANES ARE CLOSED ON LAKE ASHTON BOULEVARD.
6. ON LAKE ASHTON BOULEVARD, COMPLETE RECONSTRUCTION OF THE NORTHBOUND ROADWAY BEFORE STARTING THE SOUTHBOUND ROADWAY.
7. A REVISION TO THE TCP SHALL BE PREPARED FOR ANY LANE OR ROAD CLOSURE(S) REQUIRED FOR THE PROJECT THAT ARE NOT INCLUDED IN THE APPROVED TCP. THE TCP REVISION SHALL BE SUBMITTED TO THE ENGINEER FOR REVIEW AND APPROVAL AT LEAST TWO WORKING DAYS BEFORE THE DATE THE CLOSURE IS NEEDED FOR THE WORK. NO WORK SHALL OCCUR WITHOUT AN APPROVED TCP REVISION. THE COST FOR PREPARING THE TCP REVISION SHALL BE INCLUDED IN THE LUMP SUM PRICE FOR MAINTENANCE OF TRAFFIC PAY ITEM 102-1.
8. ROAD CLOSURES SHALL BE COORDINATED WITH THE AUTHORIZED LAKE ASHTON HOMEOWNERS' ASSOCIATION REPRESENTATIVE AND THE ENGINEER. THE COST FOR THIS COORDINATION, BROCHURES, FLYERS AND DOOR HANGERS SHALL BE INCLUDED IN THE LUMP SUM PRICE FOR MAINTENANCE OF TRAFFIC PAY ITEM 102-1.
 - a. PREPARE A PROJECT CONSTRUCTION PLAN BROCHURE OR FLYER FOR DISTRIBUTION TO THE RESIDENTS IN LAKE ASHTON. THE PROJECT CONSTRUCTION PLAN WILL LIST THE DATES ROADWAYS WILL BE CLOSED TO TRAFFIC AND ILLUSTRATE THE CLOSED ROAD, THE ALTERNATE ACCESS ROUTE AND TEMPORARY ON-STREET PARKING LOCATIONS FOR EACH ROAD CLOSURE. COORDINATE THE ALTERNATE ROUTES AND TEMPORARY ON-STREET PARKING LOCATIONS WITH THE AUTHORIZED LAKE ASHTON HOMEOWNERS' ASSOCIATION REPRESENTATIVE AND THE ENGINEER.
 - b. TWO WORKING DAYS BEFORE ANY ROAD CLOSURE, DISTRIBUTE A DOOR-HANGER CARD TO ALL RESIDENCES WITHIN THE SECTION OF ROAD TO BE CLOSED INDICATING THE EXPECTED DATE(S) AND TIMES OF THE BEGINNING AND END OF THE ROAD CLOSURE. COORDINATE DISTRIBUTION OF THE DOOR HANGERS WITH THE AUTHORIZED LAKE ASHTON HOMEOWNERS' ASSOCIATION REPRESENTATIVE AND THE ENGINEER.

LAKE ASHTON COMMUNITY
DEVELOPMENT DISTRICT
LAKE ASHTON
PAVEMENT IMPROVEMENTS
GENERAL NOTES AND
PAY ITEM LIST

DESIGN: MDC & JOB
CHECKED: BFF
APPROVED: KSK
SHEET NO. 100009308
REV. 1
G101

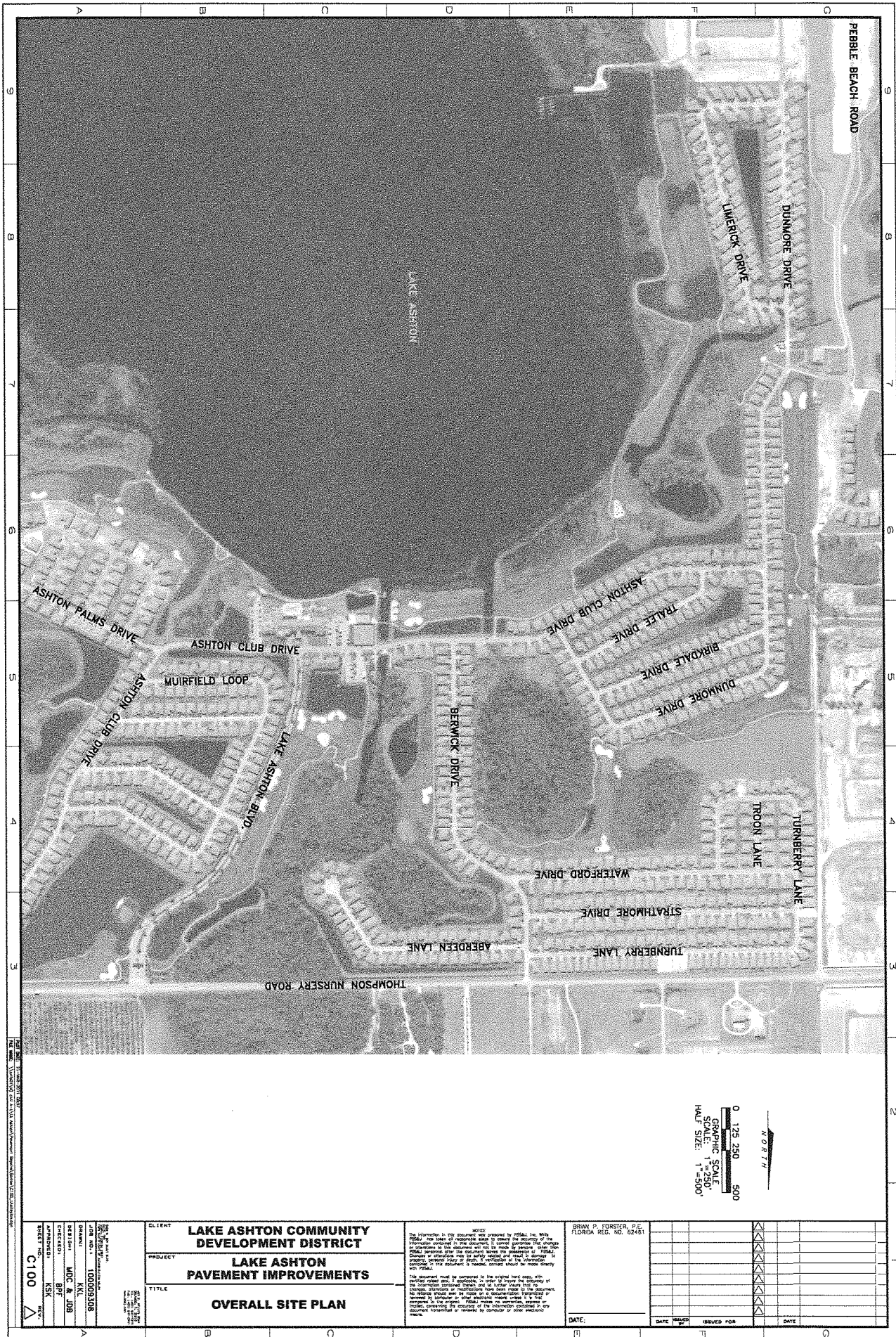

NORTH
0 125 250 500
GRAPHIC SCALE
HALF INCH = 500'

DATE: 11/11/2011
DRAWN BY: KSL
CHECKED BY: MDC & JDB
APPROVED BY: KSK
SHEET NO. C100

CLIENT: LAKE ASHTON COMMUNITY DEVELOPMENT DISTRICT
PROJECT: LAKE ASHTON PAVEMENT IMPROVEMENTS
TITLE: OVERALL SITE PLAN

NOTES:
The information in this document was prepared by the City of Lake Ashton, Florida, and is not to be used for any other purpose without the written consent of the City of Lake Ashton, Florida.
The information in this document is not to be used for any other purpose without the written consent of the City of Lake Ashton, Florida.
The information in this document is not to be used for any other purpose without the written consent of the City of Lake Ashton, Florida.

DATE: 11/11/2011
DRAWN BY: KSL
CHECKED BY: MDC & JDB
APPROVED BY: KSK
SHEET NO. C100





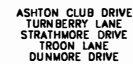

CLIENT	PROJECT	TITLE
100009308 KKL MDC & JDB BPF KSK SHEET NO. C110		

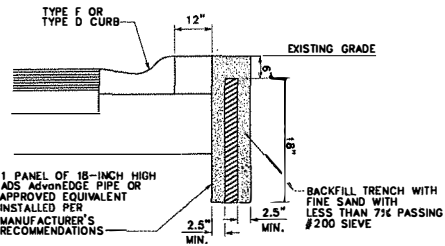

- NOTES:
1. DISTURBED AREAS TO BE RE-SODED AND RETURNED TO ORIGINAL CONDITION.
 2. CARRIER PIPE LENGTHS ARE INCLUDED IN STRIP DRAIN LENGTHS IN PAY ITEM LIST.

1 STRIP DRAIN DETAIL
N.T.S.

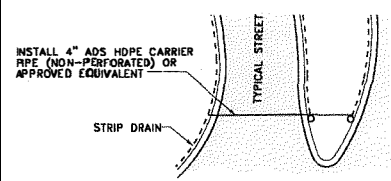

PLAN VIEW (PAVEMENT)

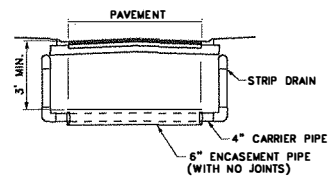

SECTION VIEW (PAVEMENT)

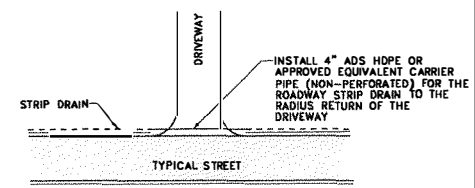

PLAN VIEW (DRIVEWAY)

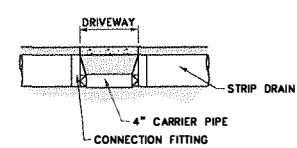

SECTION VIEW (DRIVEWAY)

2 LOCATION 4\"/>

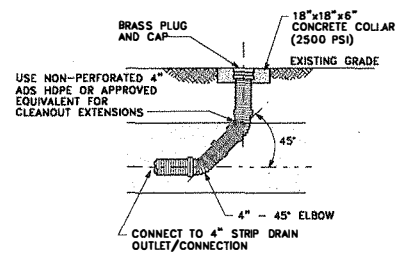

3 STRIP DRAIN CLEANOUT
N.T.S.

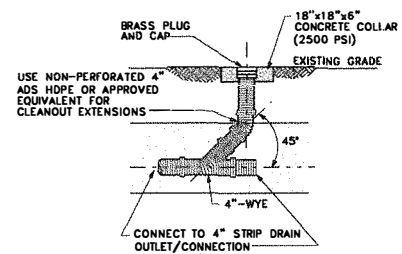

4 INLINE CLEANOUT
N.T.S.

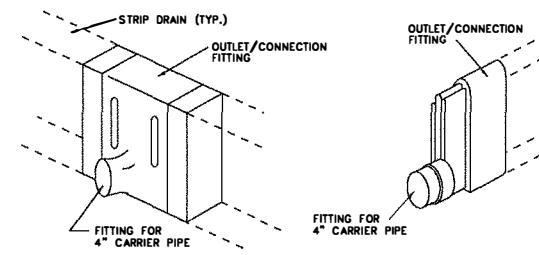

5 OUTLET / CONNECTION DETAILS
N.T.S.

- STRUCTURE CONNECTION NOTES:
1. PROPOSED INVERTS ARE SHOWN ON PLANS AND HOLES SHALL BE CORE-DRILLED ACCORDINGLY.
 2. FIVE (5) FEET OF 4" CARRIER PIPE SHALL BE USED TO CONNECT UNDERDRAIN TO STRUCTURE.
 3. PIPE CONNECTIONS TO MANHOLES, INLETS, AND PIPE SHALL BE SEALED WITH NON-SHRINK GROUT AND NEATLY FINISHED.

LAKE ASHTON COMMUNITY DEVELOPMENT DISTRICT
LAKE ASHTON PAVEMENT IMPROVEMENTS
DRAINAGE DETAILS

CLIENT	LAKE ASHTON COMMUNITY DEVELOPMENT DISTRICT
PROJECT	LAKE ASHTON PAVEMENT IMPROVEMENTS
TITLE	DRAINAGE DETAILS
DATE	11/11/2011
DESIGNED BY	KKL
CHECKED BY	BPF
APPROVED BY	KSK
SHEET NO.	C111